

Ancient Corinth with Panayia Field

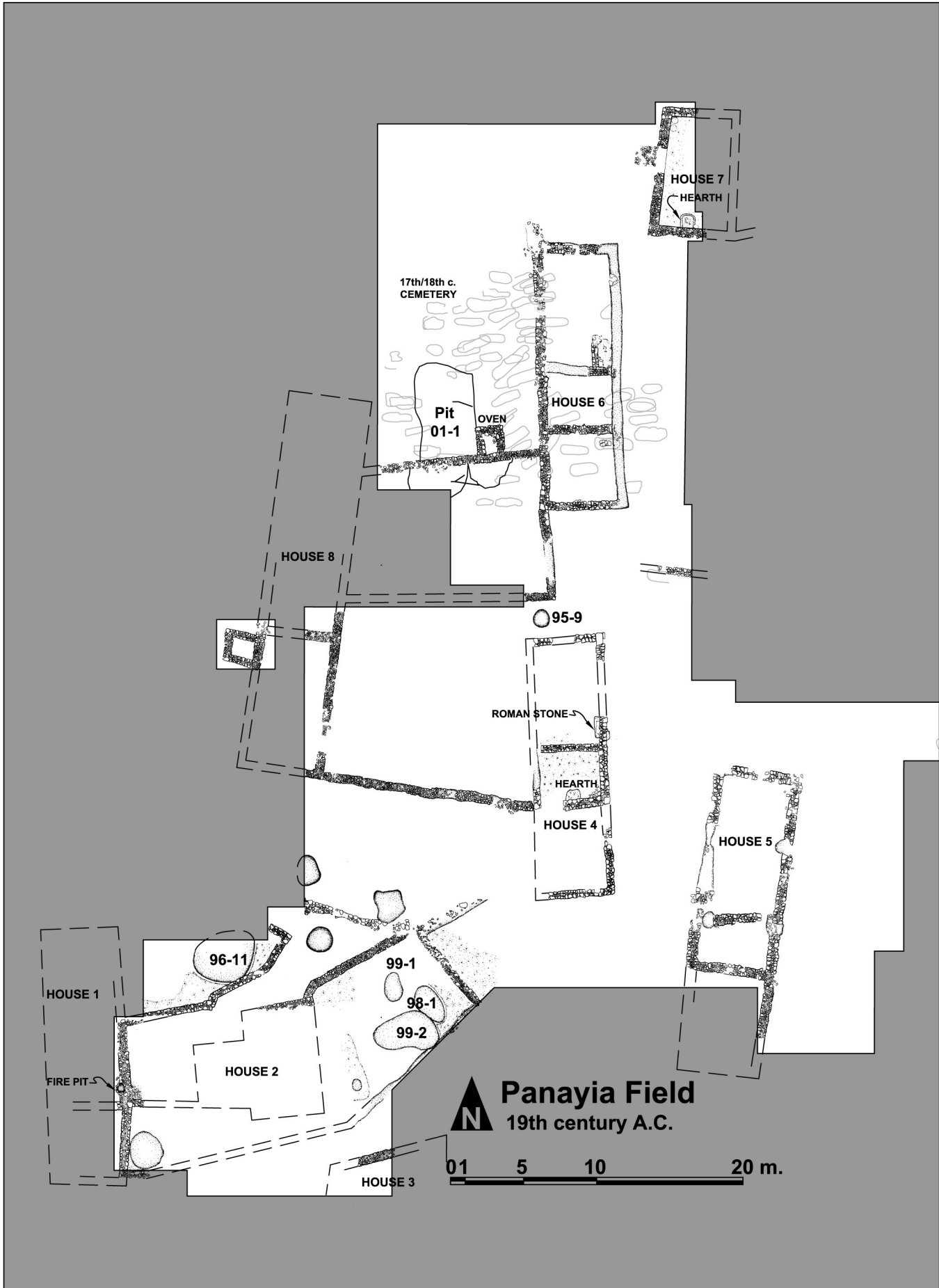

17th/18th c.
CEMETERY

HOUSE 7
HEARTH

Pit
01-1

OVEN

HOUSE 6

HOUSE 8

95-9

ROMAN STONE

HEARTH

HOUSE 4

HOUSE 5

HOUSE 1

96-11

99-1

98-1

99-2

HOUSE 2

FIRE PIT

HOUSE 3



Panayia Field
19th century A.C.

0 5 10 20 m.

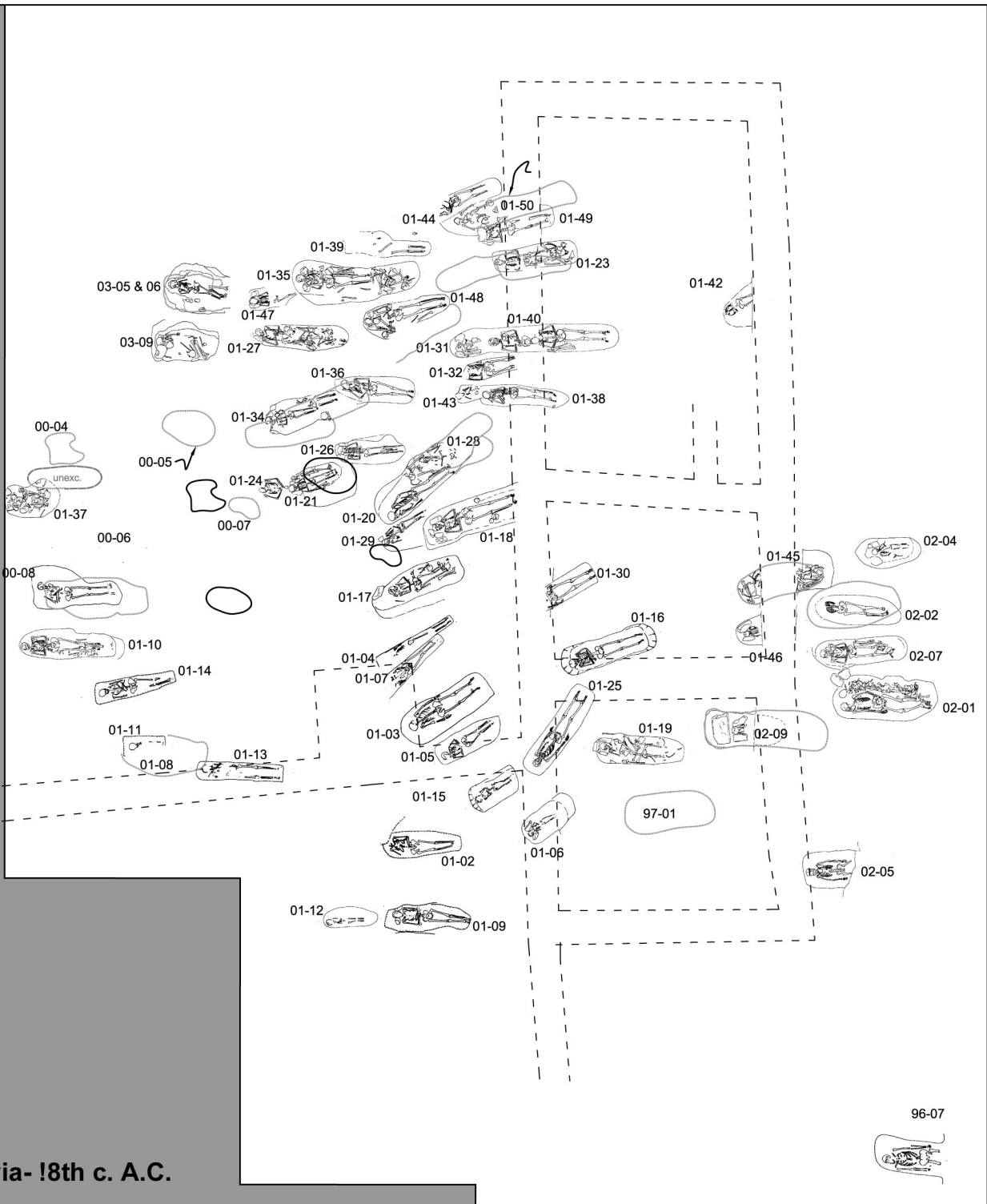

Panayia- 18th c. A.C.

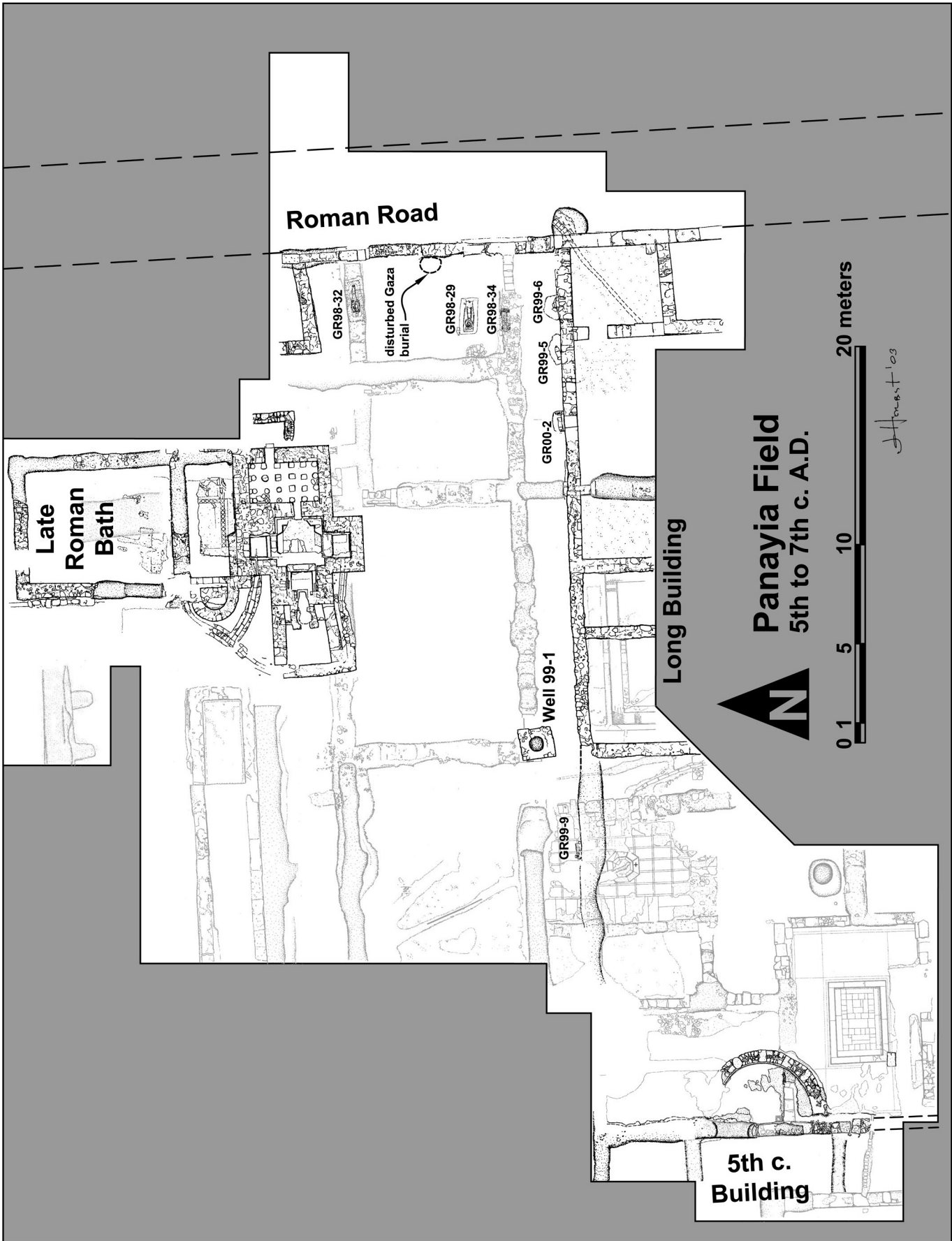

Roman Road

Late Roman Bath

disturbed Gaza burial

GR98-32

GR98-29

GR98-34

GR99-5

GR99-6

GR00-2

Well 99-1

Long Building

Panayia Field
5th to 7th c. A.D.



20 meters

10

5

0 1

Horsst 103

5th c.
Building

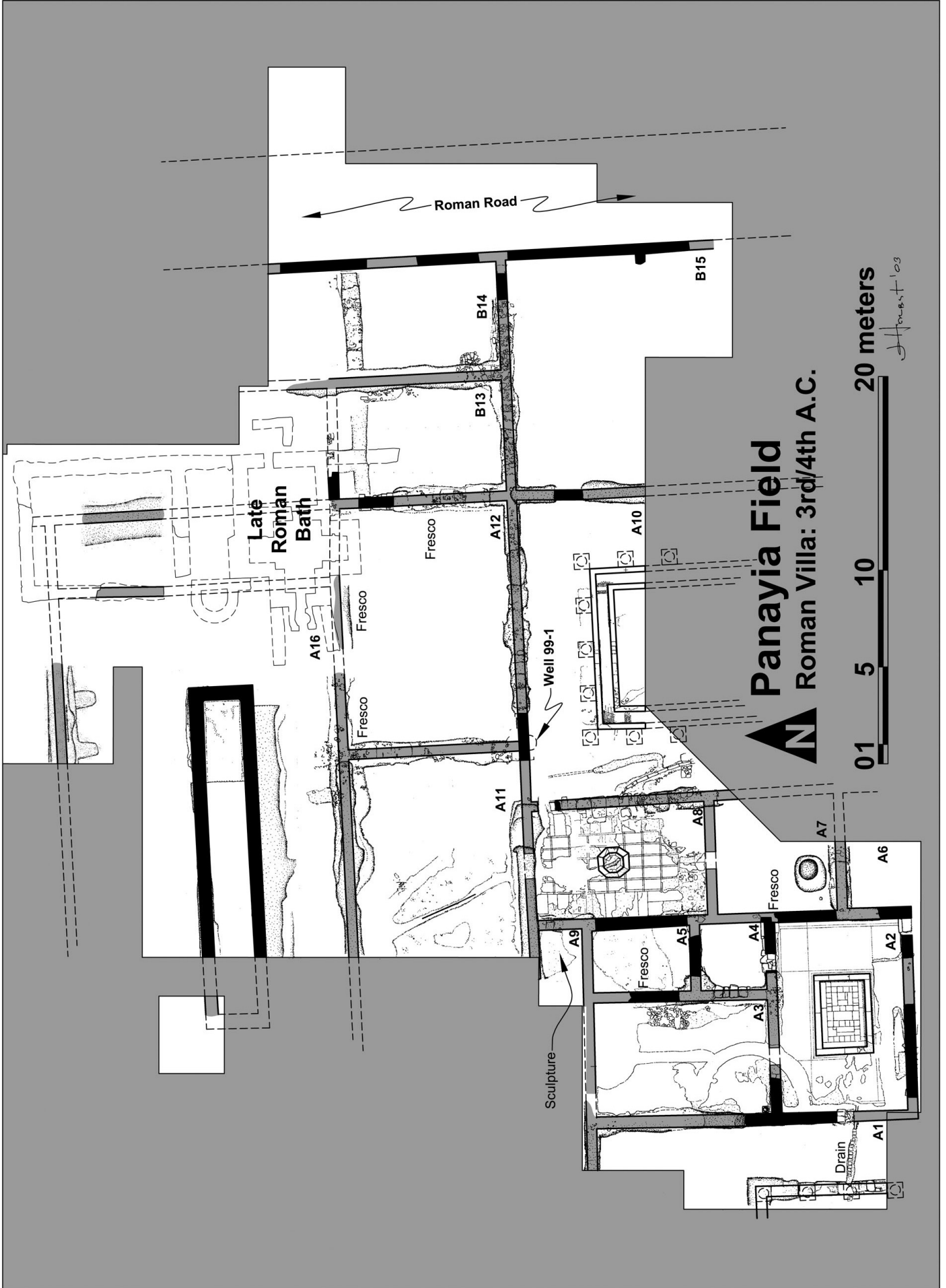

Panayia Field

Roman Villa: 3rd/4th A.C.



H. Forest '03

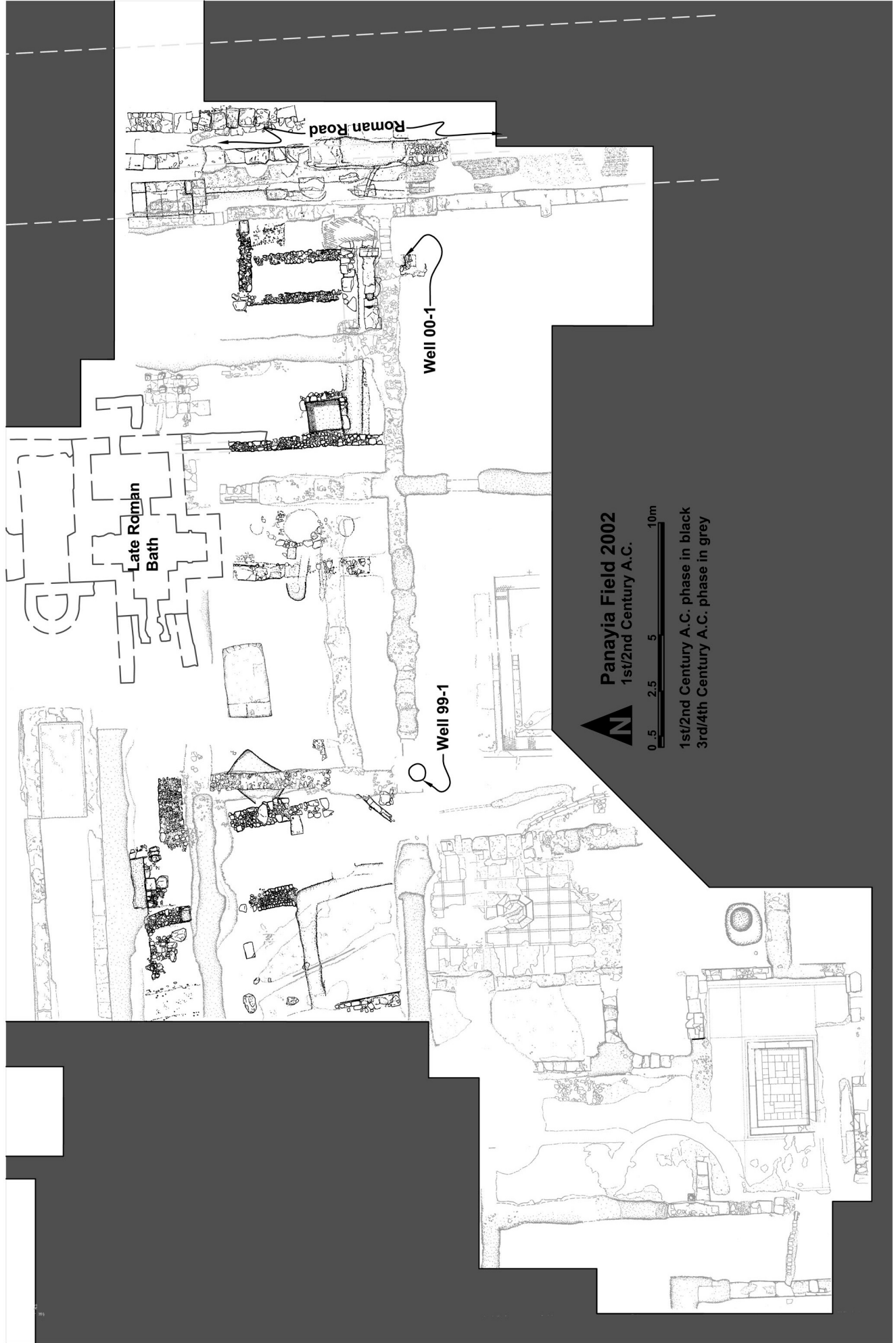

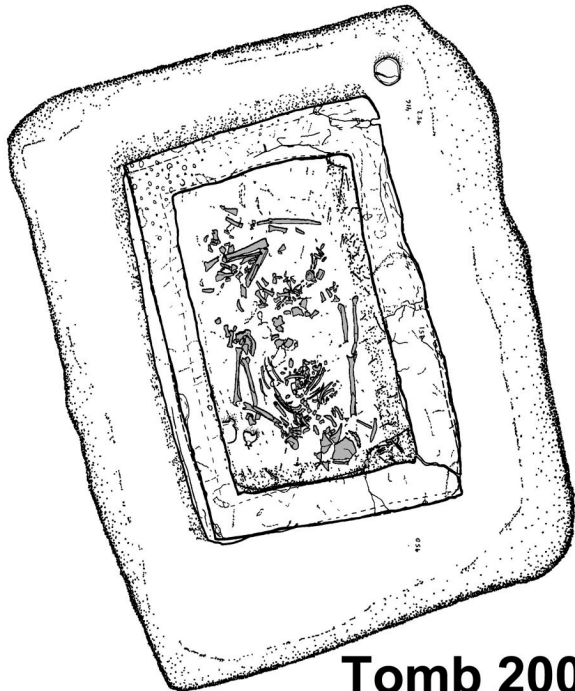

Tomb 2003-12

**Hellenistic
Disturbance**

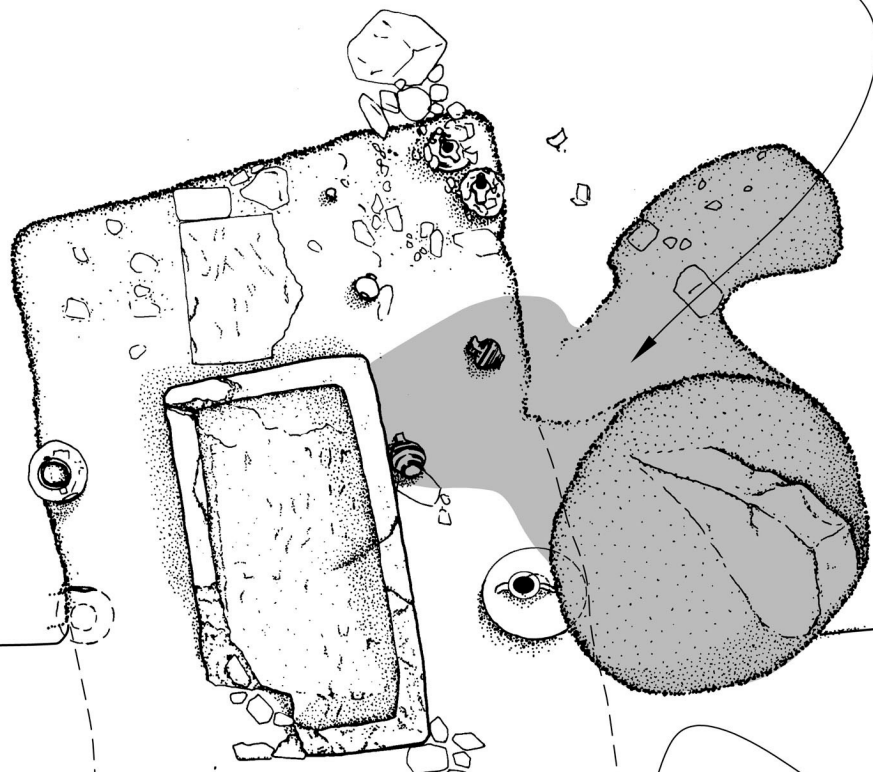

Roman Robbing Trench

Panayia- Geometric

Tomb 2002-11

American School of Classical Studies Corinth Excavations

Panayia Field (w/ bulks overlay)

19th c. A.C.
12th c. A.C.
6th/7th c. A.C.
3rd/4th c. A.C.
Pre-3rd c. A.C.

