

FRANKISH CORINTH, 1996: THE COINS

(PLATE 53)

THE EIGHTH SEASON of excavation of the Frankish Complex produced 245 coins, most of them of billon or bronze, of which it has been possible to read 219 pieces.¹ Most of them come from relatively young strata, which explains, as it did in the past seasons of excavation in the same area, the better-than-average ratio of readable coins to the total number recovered: better than 89 percent. (In the preceding seven years the ratio has ranged from 86 to 75 percent.) This report also includes a small number of coins (25 specimens) found in the Frankish Complex in past seasons (1990–1995) but somehow omitted from the earlier accounts. Of the sum total of all these coins, most were in an advanced state of decay, few of them qualifying as museum pieces. Advice in deciphering coins, rare and otherwise, came from several colleagues. I am in their debt.²

The coins included in the Catalogue fall into the following categories:

Greek	20
Roman	29 (1 Republican)
Byzantine	110 (21 Latin)
French	11 (5 seigneurial)
English	2
Sicilian Kingdom	1
Cypriot Kingdom	1
Kingdom of Hungary	1
Islamic	16 (1 Seljuq)
Frankish	53 (16 imitations)
<hr/>	
TOTAL	244

Their dates range from the 4th century B.C. to the 19th century after Christ.

The Stratigraphic List appended below comprises important coin-bearing fills collected from the buildings and other features of Units 1, 2, 3, and 5 of the Frankish Complex. Special emphasis has been given to several bothroi or pits dug between 1994 and

¹ For the report of this excavation as a whole see Williams, Barnes, and Snyder 1997.

² It is also my pleasure to acknowledge the help of Charles K. Williams and of Nancy Bookidis, Director and Assistant Director of the Excavations, respectively, the first for discussing with me various aspects of the dig, and the second for supervising the registration of the coins at the time of excavation. Special thanks are due to Stella Bouzakis, Conservator, and to the members of the potmending team, Nikolas Didaskalou, Anastasios Papaioannou, and George Arberores, for undertaking with patience and skill the task of coin cleaning. Finally, Ino Ioannidou and Lenio Bartzioti, excavation photographers, deserve recognition for their skill in dealing with some particularly trying coins.

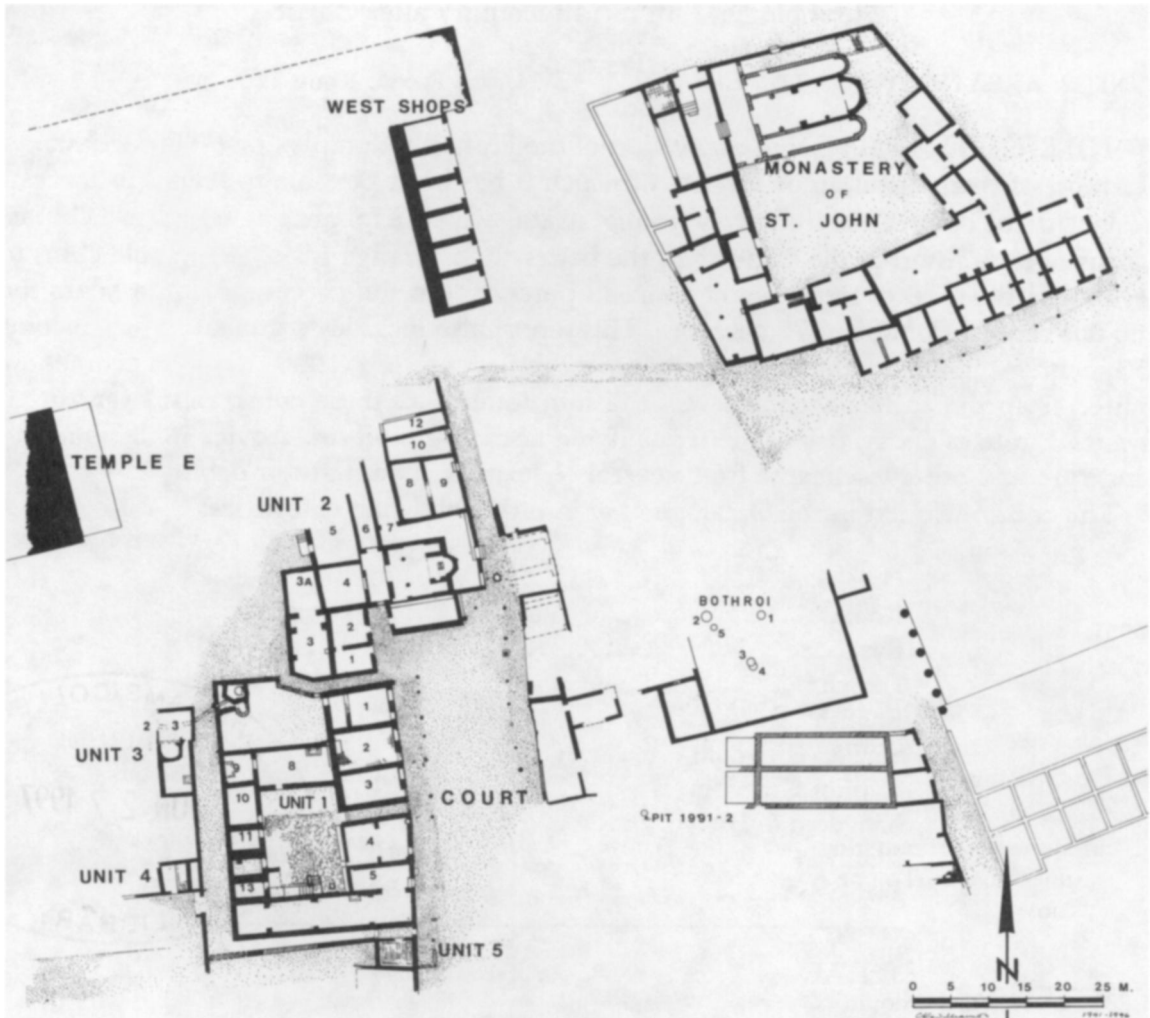

FIG. 1. General plan, west side of Frankish Corinth, southeast of Temple E

1996 in the western trenches of the excavation (mainly west of Units 1 and 2). For a plan of the pertinent structures see Figure 1. As usual, the Stratigraphic List uses pottery lots and excavation baskets to facilitate reference to the Corinth records.³ “Pocket” is my own designation for matter collected in one or more baskets from which generally only coins have been inventoried.

³ Notebooks nos. 845, 853, 856, 861, 865, 866, 872, 875, 879, 880, 883, 884, 886, 888, and 899.

THE FRANKISH COMPLEX: STRATIGRAPHIC LIST

Chronology: 13th to 14th century after Christ

UNIT 2: AREA NORTH OF THE CHURCH			V. UPPER FLOOR, ROOM 12	
I. TOP CRUST OF FLOOR DIRECTLY BENEATH DESTRUCTION DEBRIS, ROOM 9 AND ENTRANCEWAY BETWEEN ROOMS 8 AND 9			<i>Pocket (Basket 144)</i> 96-283 Corinth (duoviri) No. 6	
<i>Lot 1995-16 (Baskets 33, 169*)⁴</i>			VI. LOWER FLOOR, ROOM 12	
95-353	Isabelle ⁵	No. (93)	<i>Pocket (Basket 154)⁸</i>	
95-355	Theodore Ducas	(54)	96-289	Late Byzantine No. 60
95-358	W. de la Roche	(95)	96-290	Manuel I 52
96-163	W. Villehardouin	95		
96-164	Sikyon	9		
96-165	Argos	12		
			CHURCH PROPER	
II. DESTRUCTION DEBRIS ON TOP OF FLOOR, ROOM 10B			VII. FILL BENEATH MARBLE PAVEMENT, NARTHEX	
<i>Lot 1996-53 (Basket 86)</i>			<i>Lot 1996-57 (Basket 8)</i>	
96-231	Manuel I	No. 54	96-328	Corinth (P/T) No. 2
III. ASH DEPOSIT BENEATH FLOOR, ROOM 10B			UNIT 1: OPEN-AIR SPACE BEHIND ROOMS 1 AND 2 (GARDEN) ⁹	
<i>Pocket (Basket 88)⁶</i>				
96-233	Manfred	No. 78		
IV. ASH DEPOSIT CUTTING THROUGH UPPER FLOOR AND LYING ON TOP OF LOWER FLOOR, ROOM 12			VIII. MISCELLANEOUS FILLS, PIT 1996-10 ¹⁰	
<i>Pocket (Basket 143)⁷</i>			<i>Lot 1996-19 (Basket 28)</i>	
96-281	W. Villehardouin	No. 96	96-77	Manuel I No. 56
96-282	" "	97	<i>Lot 1996-22 (Basket 33)</i> <i>(beneath lot 1996-19)</i>	
			96-107	Greek (by fabric) No. —

⁴ Numbers of baskets excavated in past seasons but included in this Stratigraphic List are marked with an asterisk (*). The catalogue numbers of the coins involved (from Williams and Zervos 1994, 1995, and 1996) are shown in parentheses. Coins 96-163, 96-164, and 96-165, of basket 33, though excavated in 1996, were added to last season's lot 1995-16. These three coins came from the north part of room 9.

⁵ Counterfeit coin.

⁶ Basket 88 is probably to be equated with lot 1996-56 (basket 168), which contained no coins.

⁷ Basket 143 was excavated as part of bone lot 1996-39.

⁸ Basket 154 is probably equivalent with baskets 145, 146, and 147, which, dug as lot 1996-52, constitute the lower floor of room 12.

⁹ For other fills collected from the Garden, see Stratigraphic Lists of earlier reports: Williams and Zervos 1993, p. 37, Group IV; Williams and Zervos 1994, p. 44, Group XV; and Williams and Zervos 1995, p. 44, Group XVI. In the first two of these reports the Garden is referred to as "Northwest Court".

¹⁰ This pit is recorded in the Corinth deposit index as "well 1996-1".

AREA SOUTH OF UNIT 1: UNIT 5 AND EAST-WEST ROAD		95-276	<i>Pocket (Basket 105*)</i> Anonymous follis	No. (37)
IX. DESTRUCTION DEBRIS ON TOP OF FLOOR, CORRIDOR (UNIT 5)		95-277	<i>Pocket (Basket 106*)</i> Julian	No. (17)
<i>Lot 1995-54 (Basket 65*)</i> ¹¹				
95-387	Philip of Savoy	No. (94)		
X. FILL ON TOP OF UPPERMOST ROAD METAL AND BENEATH CORRIDOR, ¹² EAST-WEST ROAD				
<i>Lot 1995-49 (Basket 90*)</i>				
95-134	Alexius I	No. (44)		
XI. UPPER ROAD METALS, EAST-WEST ROAD				
<i>Pocket (Basket 91*)</i> <i>(beneath basket 90)</i> ¹³				
95-243	<i>Minimus</i>	No. —		
<i>Pocket (Basket 97*)</i>				
95-244	Late Roman	No. (24)		
<i>Lot 1995-50 (Basket 98*)</i>				
95-256	Alexius I	No. (43)		
95-257	<i>Minimus</i>	—		
95-258	"	—		
95-259	"	—		
95-260	"	—		
95-261	"	—		
95-262	Alexius I	(42)		
95-263	Manuel I	(48)		
95-264	Alexius I	(42)		
95-265	Manuel I	(48)		
95-269	Theodosius I	(21)		
95-271	<i>Minimus</i>	—		
95-273	Isaac II	(53)		
95-408	Late Byzantine	(55)		
<i>Pocket (Basket 99*)</i>				
95-268	<i>Minimus</i>	No. —		
95-270	Late Roman	(24)		
95-272	<i>Minimus</i>	—		
XII. LOWER ROAD METALS, EAST-WEST ROAD				
<i>Pocket (Basket 118*)</i> <i>(beneath basket 106)</i> ¹⁴				
95-283	Late Roman	No. (24)		
<i>Pocket (Basket 126*)</i>				
95-290	Constans	No. (12)		
95-291	Late Roman	(24)		
95-292	Constantius II or Julian	(18)		
95-293	Late Roman	(24)		
<i>Pocket (Basket 136*)</i>				
95-297	Julian	No. (17)		
XIII. DESTRUCTION ON TOP OF FLOOR, ROOM 1 (UNIT 5)				
<i>Lot 1996-47 (Basket 64)</i>				
96-250	W. or Guy II de la Roche	No. 108		
96-255	Manuel I	56		
<i>Lot 1996-48 (Baskets 20, 66)</i> <i>(beneath lot 1996-47)</i>				
96-176	(cut) Charles I or II	No. 99		
96-240	Bela I and Stephen	80		
96-241	(bent) Philip of Tarentum	111		
96-242	Late Roman	30		
PUBLIC SQUARE (NORTHWEST PASSAGE) BETWEEN UNITS 1 AND 2				
XIV. PIT 1994-3, DUG INTO THE PUBLIC SQUARE				
<i>Lot 1994-60 (Baskets 100*, 101*, 102*, 103*)</i> ¹⁵				
94-101	Latin imitative	No. (80)		
94-114	W. de la Roche	(125)		
94-115	Manuel I	(64)		
94-117	Late Roman (by fabric)	—		
94-118	Anonymous follis	(55)		

¹¹ East end of corridor, directly north of room 1 (Unit 5).

¹² Portion of the corridor, northwest of room 1 (Unit 5).

¹³ See Group X above.

¹⁴ See Group XI above.

¹⁵ By oversight, the coins of lot 1994-60 were assigned to pit 1994-4, instead of pit 1994-3, in last year's report: Williams and Zervos 1996, pp. 33-34. The coins associated with pit 1994-4 are listed in this Stratigraphic List as Group XXIX, p. 178 below.

94-119	Late Roman	(39)	XVIII. PIT DUG INTO UNIT 3 (FIRST PHASE) ¹⁹
94-138	Late Roman (by fabric)	—	
			<i>Pocket (Basket 21*)</i>
			95-360 Latin imitative No. (59)
			95-361 Manuel I (49)
			95-362 " " (48)
			95-363 " " (48)
			95-364 Latin imitative (59)
NORTH-SOUTH ROADWAY WEST OF UNITS 1 AND 2 AND AREA DIRECTLY WEST OF ROADWAY: BOTHROI IN AREA NORTH OF ROADWAY GATE ¹⁶			
XV. PIT 1995-7, DUG INTO THE ROADWAY (WEST OF PUBLIC SQUARE)			
			<i>Lot 1995-29 (Basket 27*)</i>
95-365	John II	No. (45)	96-34 Anonymous follis No. 44
95-371	(cut) Philip of Tarentum	(100)	96-35 Nicephorus III 39
95-372	Constans	(13)	96-36 W. Villehardouin 95
95-373	Constantius I	(9)	
XIX. PIT 1996-1, DUG INTO UNIT 3 (ROOM 2) ²⁰			
			<i>Lot 1996-4 (Baskets 145, 147)</i>
			96-118 W. Villehardouin No. 96
			96-126 Late Roman 30
			96-127 W. Villehardouin 96
			96-128 Late Roman 30
			96-129 Greek (uncertain) 18
XX. PIT 1996-3, DUG INTO UNIT 3 (ROOM 3) ²¹			
			<i>Lot 1996-27 (Baskets 65, 68, 69)</i>
			96-166 Late Byzantine No. 60
			96-172 Seljuqs of Syria (?) 83
			96-194 Manuel I 54
XXI. PIT 1996-4, DUG INTO UNIT 3 (ROOM 3)			
			<i>Lot 1996-28 (Baskets 104, 105)</i>
			96-182 Latin imitative No. 62
			96-198 " " 65
			96-199 " " 67
			96-200 " " 67
			96-201 " " 64
XXII. PIT 1996-5, DUG INTO UNIT 3 (ROOM 3)			
XVII. PIT 1995-5, DUG INTO UNIT 3 (FIRST PHASE)			
			<i>Lot 1995-26 (Baskets 92*, 94*)</i>
95-314	Manuel I	No. (48)	96-182 Latin imitative No. 62
95-316	Late Byzantine (trachy)	(67)	96-198 " " 65
95-317	Louis VIII or IX	(70)	96-199 " " 67
95-318	Manuel I	(47)	96-200 " " 67
95-319	Constans	(14)	96-201 " " 64

¹⁶ The gate was erected across the north-south roadway at a location just north of the southwest corner of the Garden of Unit 1; see Williams and Zervos 1996, p. 4, fig. 3, and p. 31, fig. 10.

¹⁷ The list of coins from pit 1995-6 given here supersedes the list in Williams and Zervos 1996, p. 33, no. 1.

¹⁸ Imitation.

¹⁹ The fill from this pit (bothros 6, Notebook 880, p. 36) has no Deposit Index number.

²⁰ Room 2 of Unit 3 lies directly to the west of room 3, which abuts the north-south roadway (Fig. 1). Pit 1996-1 cuts into a portion of the north-south wall that separates room 2 from room 3.

²¹ This bothros and the following three bothroi (pits 1996-4, 1996-5, and 1996-6) perforate the lowest floor of room 3; see Williams, Barnes, and Snyder 1997, pl. 14:a (in this volume).

- XXIII. PIT 1996-6, DUG INTO UNIT 3 (ROOM 3)
Lot 1996-30 (Basket 142)
 96-217 Manuel I No. 55
- BOTHROI IN AREA
 SOUTH OF ROADWAY GATE²²
- XXIV. PIT 1994-6, DUG WEST OF NORTH-SOUTH
 ROADWAY, IMMEDIATELY NORTH OF UNIT 4
Lot 1994-53 (Baskets 59, 60*)*
 94-179 Greek (by fabric) No. —
 94-180 W. Villehardouin (113)
 94-181 Corinth (tessera) (4)
 94-187 French or Frankish —
 94-196 Nicephorus III (48)
 94-197 St. Martin of Tours (88)
- XXV. PIT 1996-9, DUG INTO ROAD GRAVEL
 SOUTH OF UNIT 4
Lot 1996-68 (Basket 71)
 96-69 Late Byzantine No. 60
 96-70 Manuel I 55
- XXVI. PIT 1994-7, WITHIN NORTH-SOUTH
 ROADWAY WEST OF ROOM 9 (UNIT 1)
Lot 1994-59 (Basket 21)*
 94-137 Charles I (Provence) No. (92)
 94-143 Roman Republican (14)
- XXVII. PIT 1994-5, DUG INTO THE NORTH-SOUTH
 ROADWAY WEST OF ROOM 10
 (UNIT 1)
Lot 1994-13 (Baskets 118, 119*)*
 94-126 Louis IX No. (85)
 94-128 Late Roman (39)
- XXVIII. ROBBED-OUT WALL OR PIT IMMEDIATELY
 EAST OF UNIT 4 (IN LINE WITH WEST
 WALL OF NORTH-SOUTH ROADWAY)²³
Lot 1994-57 (Baskets 70, 110*)*
 94-209 W. Villehardouin No. (116)
 94-266 Louis VIII or IX (87)
 94-267 French or Frankish —
- XXIX. PIT 1994-4, DUG INTO THE NORTH-SOUTH
 ROADWAY NEAR THE SOUTHEAST CORNER
 OF UNIT 4²⁴
Pocket (Baskets 68, 69*)²⁵*
 94-207 W. Villehardouin No. (114)
 94-208 Late Byzantine (72)
 94-210 *Minimus* —
 94-211 Suleyman I (100)
 94-212 Late Byzantine (71)
 94-422 Late Roman (by fabric) —

CATALOGUE

The following conventions are used in this catalogue: (1) silver and billon coins are indicated by numbers in *italic type*; (2) an asterisk (*) means that commentary follows at the end; (3) a double dagger (‡) means that the piece is illustrated on Plate 53.

The following abbreviations are used in this catalogue (for full references see Bibliography, pp. 191–192 below).

Am.	= Amandry 1988
Ed.	= <i>Corinth</i> VI
Fisher	= Williams and Fisher 1975
M.	= Metcalf 1995
Seaby	= D. R. Sear <i>et al.</i> 1987
Syd.	= Sydenham 1975

²² For the location of the gate see note 16 above.

²³ This excavated space may represent the robbing trench of the southern end of the west wall, which was later widened to form a bothros or pit.

²⁴ This fill was situated close to but was distinct from the fill of lot 1994-57, Group XXVIII above. On the coins misattributed to pit 1994-4 in last year's report see note 15 above.

²⁵ Contamination, coin 94-211 (Suleyman I, A.D. 1520–1566).

GREEK COINAGE (20)

CORINTH

1.	14 mm	400–146 B.C.	Pegasos flying r./Trident. Aphlaston	<i>CopSNG</i> 180	96-293
2.	12 mm	” ”	Same. Torch	<i>BMC</i> 441	96-328
*3.	14 mm	” ”	Same. Δ – I, pinecone	<i>BMC</i> 453	‡96-267
4.	12 mm	” ”	Same. E – . . .	cf. <i>BMC</i> 455	96-183
5.	12 mm	” ”	Same. Uncertain controls		96-59

DUOVIRI

6.	23 mm	<i>Iulius-Certus</i> 44–43 B.C.	Head r./Bellerophon on Pegasos	Am. Ia	96-283
7.	20 mm	<i>Candidus-Flaccus</i> A.D. 54–55	Nero head (or Agrippina bust) r./ Poseidon in biga of hippocamps	Am. XX	96-85

ANONYMOUS ISSUE

8.	12 mm	40–30 B.C.	Rudder/Trident	Am. F4	96-40
----	-------	------------	----------------	--------	-------

OTHER GREEK STATES

PELOPONNESOS

9.	12 mm	<i>Sikyon</i> 330–200 B.C.	Dove r./Σ in wreath	Warren 4A.5	96-164
10.	16 mm	after 330 B.C.	Dove l./Tripod(?) in wreath	cf. Warren 6A.2	96-72
*11.	26 mm	<i>Patrae</i> Commodus A.D. 176–192	Head r./Priestess(?) in cart driven by oxen	Ed. NOT	‡96-68
12.	11 mm	<i>Argos</i> 350–228 B.C.	Wolf head l./A large	<i>BMC</i> 98-105	96-165

PHRYGIA

13.	23 mm	<i>Apameia</i> 133–48 B.C.	Athena bust r./Eagle over maeander symbol	<i>BMC</i> 37, 44, etc.	‡96-269
-----	-------	-------------------------------	--	-------------------------	---------

UNCERTAIN SELEUCID KING

14.	19 mm	after 323 B.C.	Head r. laureate (Apollo?)/ Tripod lebes, ΒΑΣΙΛΕΩΣ		‡96-277
-----	-------	----------------	---	--	---------

ORESTES H. ZERVOS

UNCERTAIN GREEK STATE

15.	19 mm	400–31 B.C.	Athena head r. in Corinthian helmet/ Effaced	96-326
16.	17 mm	" "	Similar/Effaced	96-243
17.	13 mm	" "	Pegasos flying l. (?)/Effaced	94-442
18.	12 mm	" "	Trident head (?)/Effaced	96-97 96-129
19.	21 mm	Imperial	Bust r./Effaced	90-337

ROMAN REPUBLICAN COINAGE (1)

Moneyer: C. Valerius Flaccus

20.	Den.	82–81 B.C.	Victory bust r./Legionary eagle, two standards. Uncertain control	Syd. 747 ‡96-24
-----	------	------------	--	--------------------

ROMAN IMPERIAL COINAGE (28)

DIOCLETIAN, A.D. 284–305

21.	22 mm	<i>Uncertain</i> A.D. 295–299	CONCORDIA MILITVM Emperor, Jupiter	cf. <i>RIC</i> VI, 15 94-436
-----	-------	----------------------------------	---------------------------------------	---------------------------------

CONSTANTINE I, A.D. 307–337

22.	15 mm	<i>Uncertain</i> A.D. 337–341	No legend. Quadriga r.	cf. <i>LRBC</i> I, 1041 96-83
-----	-------	----------------------------------	------------------------	----------------------------------

HELEN

23.	15 mm	<i>Constantinople</i> A.D. 337–340	PAX PVBLICA Pax l.	<i>RIC</i> VIII, 33 96-44
-----	-------	---------------------------------------	--------------------	------------------------------

CONSTANTIUS II, A.D. 337–361

24.	18 mm	<i>Heraclea</i> A.D. 351–355	FEL TEMP REPARATIO Falling Horseman (<i>Officina</i> Δ)	<i>RIC</i> VIII, 90 96-58
-----	-------	---------------------------------	---	------------------------------

25.	18 mm	<i>Uncertain</i>	Same (<i>Officina</i> ?)	cf. <i>LRBC</i> II, 2039 96-37
-----	-------	------------------	---------------------------	-----------------------------------

CONSTANTIUS II or JULIAN

26.	16 mm	<i>Uncertain</i>	SPES REIPVBLICE Emperor l.	96-262
-----	-------	------------------	----------------------------	--------

VALENS, A.D. 364–378

27.	18 mm	<i>Constantinople</i> A.D. 364–367	SECVRITAS REIPVBLICAE Victory l. (<i>Officina</i> Γ?)	<i>RIC</i> IX, 21c(3) 96-228
-----	-------	---------------------------------------	---	---------------------------------

VALENTINIAN II, A.D. 375–392

28. 13 mm *Uncertain* (SALVS REIPVBLICAE) cf. *LRBC* II, 2183 96-263
Victory, captive

LEO I, A.D. 457–474

29. 12 mm *Uncertain* Monogram  or var. cf. *LRBC* II, 2262 96-279
Obv. type effaced

UNCERTAIN EMPEROR

- *30. 24–10 mm *Uncertain mint*
SALVS REIPVBLICAE 96-60 Cross (with or 96-381
(or REIPVBLICE) 96-126 without legend)
Victory, captive 96-265 () Camp gate 96-242
VICTORIA AVG 96-299 Uncertain type 93-299
(or AVGG, etc.) 94-397
Two Victories 96-25
vis-à-vis 96-54
VOT X in wreath 96-266 96-81
VOT? MVLT? 91-382 96-128
94-435 96-135
96-349 96-313

UNCERTAIN COINS OF SMALL MODULE, 11 MM OR LESS (8)

BYZANTINE COINAGE (110)

JUSTIN I, A.D. 518–527

31. 27 mm *Uncertain* Bust r./K large; to l., cf. *DOC* I, 14 94-437
long cross

MAURICE TIBERIUS, A.D. 582–602

32. 28 mm *Antioch* Bust (facing)/M large; to l., *DOC* I, 162–173 96-215
A.D. 591–602 ANNO; to r., X . . . ;
(holed twice) above, +; below, €

UNCERTAIN EMPEROR

33. 13 mm *Uncertain* Bust r./€ large cf. *DOC* I, pl. 62:21 96-45

LEO VI, A.D. 886–912

34. 28–25 mm *Constantinople* Emperor bust/Inscription *DOC* III, ii, 8 96-21
A.D. 886–912 96-175

CONSTANTINE VII, A.D. 913–959

		<i>Constantinople</i>			
35.	24 mm	A.D. 914–919	Constantine and Zoe busts/ Inscription	<i>DOC III</i> , ii, 22	96-82
36.	27–24 mm	A.D. 931–944	Romanus I bust/Inscription	<i>DOC III</i> , ii, 25b	96-124 96-324
37.	26 mm	A.D. 945–950	Constantine bust/Inscription	<i>DOC III</i> , ii, 26	96-94
38.	25 mm	A.D. 950–959	Constantine and Romanus II busts/Inscription	<i>DOC III</i> , ii, 27	96-92

NICEPHORUS III, A.D. 1078–1081

		<i>Constantinople</i>			
*39.	26–23 mm (1 overstr.)	A.D. 1078–1081	Christ figure (between stars)/ C Φ Cross and circle with N Δ	<i>DOC III</i> , ii, 9	96-35 96-125

ANONYMOUS ISSUES



*40a.	28–22 mm (2 overstr.)	A.D. 969–1030	Christ bust/Four-line inscription	<i>DOC III</i> , ii, p. 648, Class A1	96-23 96-32 96-33
40b.	31–28 mm	” ”	Same/Same (Ornaments 2 and 24)	<i>DOC III</i> , ii, p. 650, Class A2	96-26 96-30 96-216 96-345
41.	28–26 mm (1 overstr.)	A.D. 1030–1042	Christ bust/Cross on steps, inscription in angles	<i>DOC III</i> , ii, p. 676, Class B	96-315 96-317 96-372
*42.	28–22 mm (1 cut down)	A.D. 1042–1050	Christ figure/Jeweled cross, inscription in angles	<i>DOC III</i> , ii, p. 681, Class C	90-358 96-50 96-234
43.	27 mm (overstr.)	A.D. 1065–1070	Christ bust/Virgin bust	<i>DOC III</i> , ii, p. 692, Class G	94-439
44.	26–23 mm	A.D. 1070–1075	Similar/Patriarchal cross	<i>DOC III</i> , ii, p. 694, Class H	96-12 96-34
45.	26–20 mm	A.D. 1075–1080	Similar/Latin cross	<i>DOC III</i> , ii, p. 696, Class I	94-438 96-31 96-52 96-100

ANONYMOUS ISSUE (IMITATION)

*46.	22 mm (1.27 g)		Christ bust/Virgin figure (cf. Class K)		96-336
------	-------------------	--	--	--	--------

ALEXIUS I, A.D. 1081–1118

		<i>Thessalonica</i>			
*47.	Tetart. (3.17–1.80 g)	A.D. 1092–1118	Christ bust/Emperor bust	Hendy, pl. 8:7	†96-57 96-150

*48.	Tetart. (2.87–2.03 g)	” ”	Virgin bust/Similar	Hendy, pl. 18:9	96-29 96-360
49.	Tetart. (3.73–2.32 g)	” ”	C Φ Cross $\Lambda \Delta$ /Similar	Hendy, pl. 8:10	95-445 96-65 96-226 96-378
ALEXIOUS I (IRREGULAR)					
*50.	Tetart. (1.78 g)	after A.D. 1092	C Φ Cross $\Lambda \Delta$ /Emperor bust	cf. Hendy, pl. 8:12	‡96-16
JOHN II, A.D. 1118–1143					
51.	Tetart. (3.29 g)	<i>Thessalonica</i> A.D. 1118–1143	Christ bust/Emperor bust	Hendy, pl. 11:11	‡96-28
MANUEL I, A.D. 1143–1180					
52.	Half-tetart. (2.23 g)	<i>Thessalonica</i> A.D. 1143–1180	 (raised Π)/Emperor bust	Hendy, pl. 17:17	96-290
<i>Unattributed</i>					
*53.	Half-tetart. (2.06–1.03 g)	A.D. 1143–1180	 /Similar (Hendy, pl. 18:1)	94-400 94-401 96-13 96-27	96-256 96-373 96-382 96-383
54.	Half-tetart. (2.32–0.74 g)	” ”	St. George bust/Emperor bust (Hendy, pl. 18:3)	94-440 95-453 96-41 96-71 96-73 96-119 96-120 96-121 96-149 96-194	96-227 96-231 96-264 96-272 96-274 96-300 96-314 96-316 96-338 96-376
55.	Half-tetart. (2.48–1.89 g)	” ”	Christ bust/Emperor figure (Hendy, pl. 18:5)	90-357 96-70	96-170 96-217 96-358
*56.	Half-tetart. (1 halved)	” ”	Cross on steps/Emperor half-figure	Hendy, pl. 18:7	‡96-77 96-255
MANUEL I (IRREGULAR)					
*57.	Half-tetart. (g —)	after A.D. 1143	 /Emperor bust	cf. Hendy, pl. 18:1	96-377

ANDRONICUS I, A.D. 1183-1185

Unattributed

- | | | | | | |
|-----|-----------------------|----------------|--|-----------------|--------|
| 58. | Half-tetart. (2.00 g) | A.D. 1183-1185 | Virgin bust with Christ/
Emperor bust | Hendy, pl. 19:4 | 93-309 |
|-----|-----------------------|----------------|--|-----------------|--------|

JOHN DUCAS (EMPIRE OF THESSALONICA), A.D. 1237-1242

Thessalonica

- | | | | | | |
|-----|--------|----------------|---|------------------------------|---------|
| 59. | Trachy | A.D. 1237-1242 | Winged cross in circle/
Emperor crowned by
St. Nicholas | Seaby 2203
(small module) | ‡96-325 |
|-----|--------|----------------|---|------------------------------|---------|

UNCERTAIN EMPEROR

Uncertain mint

- | | | | | | |
|-----|----------------------------|--|--------------------------------------|-------------------------|--------------------------------------|
| 60. | Half-tetart.
(1 halved) | | Effaced/Illegible or
Emperor bust | 96-22
96-64
96-69 | 96-166
96-271
96-289
96-362 |
|-----|----------------------------|--|--------------------------------------|-------------------------|--------------------------------------|

LATIN IMITATIVE

Constantinople

- | | | | | | |
|-----|-----------------------|-----------------|---|-----------------------------|--------|
| 61. | Trachy
(flattened) | after A.D. 1204 | Virgin with Christ, seated/
Emperor figure | Hendy, pl. 25:6
(type A) | 96-204 |
|-----|-----------------------|-----------------|---|-----------------------------|--------|

Unattributed

- | | | | | | |
|------|-------------------------|-----------------|--|--------------------------------------|---------------------------------------|
| *62. | Trachy
(1 flattened) | after A.D. 1204 | Similar/Similar
(Hendy, pl. 29:1) | 96-101
96-108
96-111
96-171 | 96-182
96-190
‡96-199
96-356 |
| 63. | Trachy | " " | Christ seated/Emperor figure | Hendy, pl. 29:4 | 96-123 |
| 64. | Trachy | " " | Similar/Emperor bust | Hendy, pl. 29:10 | 96-103
96-201
96-375 |
| 65. | Trachy | " " | Christ bust/Emperor figure | Hendy, pl. 29:13 | 96-198 |
| 66. | Trachy
(flattened) | " " | (Virgin with Christ, seated)/
Emperor with St. Theodore | Hendy, pl. 29:19 | 96-148 |

LATIN IMITATIVE (IRREGULAR)

- | | | | | | |
|-------|--------|-----------------|---|---------------------|---------|
| *67. | Trachy | after A.D. 1204 | Virgin with Christ, seated/
Emperor figure | cf. Hendy, pl. 29:1 | ‡96-102 |
| *67a. | Trachy | " " | Virgin seated(?)/
Emperor figure | cf. Hendy, pl. 29:1 | ‡96-200 |

UNCERTAIN TRACHEA

- | | | | | | |
|-----|----------|--|--|--|------------------|
| 68. | 24-17 mm | | Haloed figure/Illegible
or emperor figure | | 96-110
96-363 |
| 69. | 18-17 mm | | Effaced/Emperor bust or figure | | 94-433
96-112 |

FRENCH COINAGE (11)

PHILIP AUGUSTUS, A.D. 1180–1223

- | | | | | | |
|-----|------|----------------|--|--------------|-------|
| 70. | Den. | A.D. 1204–1220 | +PHILLIPVS RE Cross/
+SCS MARTINVS Castle | Duplessy 176 | 96-43 |
|-----|------|----------------|--|--------------|-------|

LOUIS VIII or IX, A.D. 1223–1270

- | | | | | | |
|------|-----------------|----------------|---|------------------------|--------------------------------------|
| *71. | Den.
(1 cut) | A.D. 1223–1270 | +LVDOVICVS REX Cross/
+TVRONVS CIVI (or CIVIS)
Castle | Duplessy 187
or 193 | 96-63
‡96-114
96-122
96-193 |
|------|-----------------|----------------|---|------------------------|--------------------------------------|

LOUIS XIV, A.D. 1643–1715

- | | | | | | |
|-----|---------------------|-----------|---|---------------|-------|
| 72. | 1/12 Ecu
(holed) | A.D. 1669 | +LVD XIII DG etc. Bust r./
SIT NOMEN, etc. Shield
and crown | Duplessy 1496 | 96-10 |
|-----|---------------------|-----------|---|---------------|-------|

SEIGNEURIAL

ST. MARTIN OF TOURS, before A.D. 1204

- | | | | | | |
|-----|------|------------------|--|----------|--------|
| 73. | Den. | before A.D. 1204 | +SCS MARTINVS Castle/
+TVRONVS CIVI Cross | Ed. 33 | 96-62 |
| 74. | Den. | " " | Same (but SC2/Same) | (Ed. 33) | 96-235 |

ST. MARTIN OF PHILIP AUGUSTUS

- | | | | | | |
|-----|------|--------------|------------------------------------|--|--------|
| 75. | Den. | to A.D. 1223 | +SCS MARTINVS Castle/
() Cross | | 96-270 |
|-----|------|--------------|------------------------------------|--|--------|

CHARLES I OF ANJOU, A.D. 1246–1285

- | | | | | | |
|-----|------|----------------|--|--------------------------|--------|
| 76. | Den. | A.D. 1246–1266 | +K CO P FI RE F Cross/
+PVINCIALIS Castle
(with fleur-de-lis) | Ed. 40 | 94-434 |
| 77. | Den. | " " | +K FI RE F COMES ☩ Cross/
+PROVINCIALIS Castle
(with fleur-de-lis) | cf. Poey d'Avant
3954 | 96-134 |

COINAGE OF THE KINGDOM OF SICILY (1)

MANFRED, A.D. 1258–1266

- | | | | | | |
|-----|------|----------------|---|-------------|--------|
| 78. | Den. | A.D. 1258–1266 | +MAYNFRIDVS in field,
A between two pellets/
+REX SICILIE
Cross, star in each corner | Travaini 65 | 96-233 |
|-----|------|----------------|---|-------------|--------|

COINAGE OF THE KINGDOM OF CYPRUS (1)

GUY OF LUSIGNAN (LORD OF CYPRUS), A.D. 1192–1194

- | | | | | | |
|-----|------|----------------|---|--------|--------|
| 79. | Den. | A.D. 1192–1194 | +REX GUIDO Tower with
battlements, star inside/
+DE CIPRO Cross, pellet
or crescent in corners | M. 629 | 96-357 |
|-----|------|----------------|---|--------|--------|

HUNGARIAN COINAGE (1)

BELA IV and STEPHEN, A.D. 1235–1270

- | | | | | | |
|------|------------------|----------------|--|--------------------------|---------|
| *80. | 27 mm
(holed) | A.D. 1254–1270 | +SANCTA MARIA Virgin
seated/+REX BELA, REX 2T2
Bela and Stephen seated | Engel-Serrure,
p. 889 | ‡96-240 |
|------|------------------|----------------|--|--------------------------|---------|

ENGLISH COINAGE (2)

- | | | | | | |
|-----|----|----------------|--|-------------------------------|--------|
| 81. | AR | A.D. 1189–1205 | hENRICVS R/EX Facing head/
+MEINIR ON CANT
Short cross | North, p. 220
(Class 2-4b) | 96-249 |
| 82. | AR | A.D. 1180–1247 | Same/() Short cross | Ed. 60–64 | 96-276 |

ISLAMIC COINAGE (16)

SELJUQ RULERS OF SYRIA (?)

UNCERTAIN RULER

- | | | | | | |
|------|------|----------------|----------------------------|------------------------------------|--------|
| *83. | Fals | A.D. 1085–1114 | Inscription(?)/Inscription | cf. <i>Antioch</i> IV,
155, 156 | 96-172 |
|------|------|----------------|----------------------------|------------------------------------|--------|

OTTOMAN RULERS

MEHMED III, A.D. 1595–1603

Uncertain

- | | | | | | |
|------|------------------|----------------|-------------------------|--------------|-------|
| *84. | Aqche
(holed) | A.D. 1595–1603 | Inscription/Inscription | cf. Pere 340 | 96-20 |
|------|------------------|----------------|-------------------------|--------------|-------|

MURAD IV, A.D. 1623–1640

Misir

- | | | | | | |
|------|-----------------|----------------|-------------------------|----------|---------|
| 84a. | Para
(holed) | A.D. 1623–1640 | Inscription/Inscription | Pere 421 | ‡95-441 |
|------|-----------------|----------------|-------------------------|----------|---------|

Belgrade

- | | | | | | |
|-----|-------|----------------|-------------------------|----------|------|
| 85. | Aqche | A.D. 1623–1640 | Inscription/Inscription | Pere 423 | 96-7 |
|-----|-------|----------------|-------------------------|----------|------|

Uskub(?)

- | | | | | | |
|-----|-------|----------------|---|----------|------|
| 86. | Aqche | A.D. 1623–1640 | Inscription/As obv., incuse
(brockage) | Pere 423 | 96-8 |
|-----|-------|----------------|---|----------|------|

Uncertain

- | | | | | | |
|-----|------------------|----------------|-------------------------|--------------|--------|
| 87. | Aqche
(holed) | A.D. 1623–1640 | Inscription/Inscription | cf. Pere 423 | 96-238 |
|-----|------------------|----------------|-------------------------|--------------|--------|

MEHMED IV, A.D. 1648–1687

	<i>Misir</i>				
88.	Para	A.D. 1648–1687	Inscription/Inscription	Pere 458	96-257

AHMED III, A.D. 1703–1730

	<i>Constantinople</i>				
89.	Para	A.D. 1703–1730	Inscription (tughra)/ Inscription	Pere 523	96-302

OSMAN III, A.D. 1754–1757

	<i>Constantinople</i>				
90.	Para (holed)	A.D. 1754–1757	Inscription (tughra)/ Inscription	Pere 602	96-292

ABDUL HAMID I, A.D. 1774–1789

	<i>Misir</i>				
91.	Para	A.D. 1774–1789	Inscription (tughra)/ Inscription	Pere 683	96-55

SELIM III, A.D. 1789–1807

	<i>Misir</i>				
92.	Para	A.D. 1789–1807	Inscription (tughra)/ Inscription	Pere 717	96-169

UNCERTAIN RULER

	<i>Uncertain Mint</i>				
*93.	Aqche (1 holed)		Inscription/Inscription	91-385 96-15 96-78	96-131 96-161 96-327

FRANKISH COINAGE (53)

PRINCES OF ACHAIA (32; 7 imitations)

WILLIAM VILLEHARDOUIN, A.D. 1245–1278

	<i>Achaia</i>				
94.	AE unit	after A.D. 1250	+G PRINCEPS Facing head/ +ACHAIE Cross, pellets in angles	Ed. 1	96-361
	<i>Corinth</i>				
95.	AE unit (1 cut)	after A.D. 1250	G P ACCAIE Long cross/ CORINTVM Acrocorinth castle (Ed. 2)	96-19 96-36 96-39 96-113	96-163 96-189 96-248 96-323 96-340
96.	AE unit	” ”	G P ACCAIE Cross/ +CORINTI Genoese gate (Crescents)	96-79 96-118 96-127 96-133	96-281 96-291 96-374 96-384

- | | | | | | | |
|--|-----------------------|------------------------------|---|---------|------------------------------------|--|
| | | <i>Clarenza</i> | | | | |
| 97. | Den. | A.D. 1262–1278 | +G PRINCEPS Cross/
+CLARENTIA Castle Tournois
(Dots) | Ed. 6 | 96-205
96-282 | |
| 98. | Den. | ” ” | Same (but PRINCEPS)/
Same (but CLARENTIA)
(Rosettes, dots) | (Ed. 6) | 96-359 | |
| CHARLES I or II OF ANJOU, A.D. 1278–1289 | | | | | | |
| | | <i>Clarenza</i> | | | | |
| 99. | Den.
(cut) | A.D. 1278–1283
(Tzamalis) | +K R PRINC' ACH Cross/
+DE CLARENTIA Castle Tournois
(Saltire stops, dots) | Ed. 11 | 90-369
96-176 | |
| ISABELLE VILLEHARDOUIN (imitations) | | | | | | |
| | | <i>Uncertain</i> | | | | |
| 100. | Den.
(cut or bent) | after A.D. 1297 | +YSABELLA P ACh (blundered) Cross/
+DE CLAREN CIA (blundered)
Castle Tournois | Ed. 14 | 96-42
96-47
96-203
96-342 | |
| PHILIP OF SAVOY, A.D. 1301–1307 | | | | | | |
| | | <i>Clarenza</i> | | | | |
| 101. | Den.
(cut or bent) | A.D. 1301–1307 | +PhS D SAB ACh€ Cross/
+DE CLAREN CIA Castle Tournois
(Lis, star, dots) | Ed. 16 | 96-46
96-333 | |
| PHILIP OF SAVOY (imitations) | | | | | | |
| | | <i>Uncertain</i> | | | | |
| 102. | Den.
(bent) | after A.D. 1301 | +PhS D SAB P ACh€ (blundered) Cross/
+DE CLAREN CIA (blundered)
Castle Tournois | Ed. — | 94-432
96-334 | |
| PHILIP OF TARENTUM (imitation) | | | | | | |
| | | <i>Uncertain</i> | | | | |
| 103. | Den.
(cut) | after A.D. 1307 | +PhS P ACh TAR DR (blundered) Cross/
+DE CLAREN CIA (blundered)
Castle Tournois | Ed. — | 96-67 | |
| DUKES OF ATHENS (7) | | | | | | |
| WILLIAM DE LA ROCHE, A.D. 1280–1287 | | | | | | |
| | | <i>Thebes</i> | | | | |
| 104. | AE
fraction | A.D. 1280–1287 | +G DVX ATETNES Fleur-de-lis/
+THEBE CIVIS Genoese gate
(Trefoil stops) | Ed. 21 | 96-275 | |
| 105. | Den. | A.D. 1287–1308 | +G DVX ATEINES Cross/
+THEBE CIVIS Castle Tournois,
broken annuli (Annulets) | Ed. 23 | 96-192 | |

GUY II DE LA ROCHE, A.D. 1287-1308

Thebes

*106.	Den.	A.D. 1287-1308	+GVIOT DVX ATH' Cross/ +THEBE CIVIS Castle Tournois, broken annuli (Trefoil stops)	M. 1030 (GR. 104)	96-53
-------	------	----------------	--	----------------------	-------

WILLIAM OR GUY II DE LA ROCHE, A.D. 1280-1308

Thebes

107.	AE (fraction)	A.D. 1280-1308	+G DVX ATENES Shield/ +TEBE CIVIS Cross (Treffoils, dots)	Ed. 24	96-273
108.	Den. (Tzamalis)	A.D. 1287-1308	+GVI DVX ATENES Cross/ +THEBANI CIVIS Castle Tournois (Spur-rowels, rosettes, dots)	Ed. 24	96-207 96-250 96-286

DESPOT OF EPIRUS (9; 4 imitations)

PHILIP OF TARENTUM, A.D. 1294-1313

Lepanto

*109.	Den.	A.D. 1294-1313	+PhS P TAR DESP Cross/ +NEPANTI CIVIS Castle Tournois (Leaf, lis, dots, Y, I)	Ed. 27	96-49 96-104 96-132 96-239
*110.	Den.	" "	+PhS P Ach TAR `QR Cross/ +NEPANTI CIVIS Castle Tournois (Lis, saltire, dots)	Ed. 28	96-337

PHILIP OF TARENTUM (imitations)

Uncertain

111.	Den. (cut or bent)	after A.D. 1294	+PhS P TAR DESP or var. (blundered) Cross/ +NEPANTI CIVIS (blundered) Castle Tournois	Ed. —	93-308 96-191 96-241 96-332
------	-----------------------	-----------------	--	-------	--------------------------------------

UNCERTAIN RULERS (5 imitations)

Uncertain mint

112.	Den. (cut or bent)	after A.D. 1262	Legend (blundered) Cross/ +DE CLAREN CIA or var. (blundered) Castle Tournois	Ed. 8, etc.	96-48 96-278 96-339 96-346
113.	Den.	after A.D. 1294	+DE D()IA Cross/ +NEI()IS Castle Tournois Mule: rev. "Clarenza"/rev. Philip of Tarentum		96-331

UNCERTAIN COINS OF "TOURNOIS" VARIETY (9; 8 CUT OR BENT)

NOTES

- (3) This is basically the same issue as the one in *BMC* except that the letters and symbol have switched positions in the reverse field. Here, the letters $\Delta - \text{I}$ are in the upper field, the pinecone in the lower field (Pl. 53).
- (11) IMP COMMOD-V. . . Head r., laureate.
Rev. Priestess(?) standing in high two-wheeled cart drawn by two oxen r. Above type, COL A A; in exergue, (PATR. . .). Centering depressions on rev. *Weight* 12.24 g (Pl. 53).
 This Patraic issue of Commodus is not listed in the standard references and is probably unpublished. The reverse type is known, however, from the local coinages of Septimius Severus; see *Corinth* VI, p. 55, no. 343.
- (30) Coin 96-126 is a mintage of Constantinople and has *cross-rho* in the l. field of the reverse.
- (39) Coin 96-125 (*weight* 3.29 g) is overstruck on a follis Class H(?).
- (40a) Coin 96-23 (*weight* 6.77 g) is overstruck on Nicephorus II.
 Coin 96-32 (*weight* 10.73 g) is overstruck on Nicephorus II and Constantine VII.
- (42) Coin 96-50 is cut down. *Weight* 4.09 g.
- (46) Both the paper-thin flan and the crude style of this follis suggest a counterfeit.
- (47, 48) See my earlier reports, Williams and Zervos 1988, p. 145, no. 82 and 1990, p. 368, no. 54 for a commentary on the weights of these two Thessalonican issues (Hendy's First and Second Coinages).
- (50) This tetarteron differs from the known "jeweled cross" coppers of Alexius by its omission of the reverse legend (ΤΩ ΚΟΜΝ), here replaced by ∴ (four-dot cross), and by its paper-thin fabric (Pl. 53). Similar pieces, all anomalous in one way or another, have been reported in the past from both Corinth (*Corinth* VI, p. 142, no. 122; Williams and Fisher 1975, p. 35, note 73) and the Athenian Agora (*Agora* II, p. 116, no. 1891).
Note. The third of Hendy's three illustrated "jeweled cross" tetartera (Hendy, pl. 8:12) seems to be an irregular piece similar to ours.
- (53) Coin 96-383 is unusual because of its *concave* shape. It is probably an ordinary flat half-tetarteron pounded, for some reason, into this unusual form (imperial monogram, on the hollow side).
- (56) Coin 97-77, cut in half, weighs 0.92 g. Coin 96-255 weighs 0.71 g.
- (57) This copper is unusual for both its style and its fabric (octagonal clip). It is probably an imitation.
- (62) Coin 96-199 has an unusually crude reverse type; note, for instance, the exaggerated V-shape border of the emperor's chlamys (Pl. 53). The coin cannot, however, be a barbaric imitation, as its flan bears clear traces of an undertype.
- (67) This little trachy is in every respect similar to Hendy's type A except for the imperial effigy on the reverse, depicted here with lowered r. hand instead of with raised r. hand as is proper (Pl. 53). A similar example was listed in an earlier report: Williams and Zervos 1990, p. 365, no. 63.
- (67a) Coin 96-200 is fragmentary, but enough of it is preserved to reveal its anomalous features. Like the coin mentioned in the previous note (coin 96-102), it is based on Hendy's trachy type A (small module), but the style of its obverse and reverse is barbarous. The seated Virgin (obverse) is shown as a rectangular network of lines with a tiny head attached, while the imperial form (reverse) is reduced to a "stick-figure" caricature (Pl. 53). The fabric is also noteworthy for its *shallow* trachy form. There is no doubt that this poorly made coin originated in the provinces in a hastily put together (probably illegal) workshop. Similar examples have been recovered in the past, and of these I illustrate two better-preserved

- pieces, one of them struck on a slightly concave flan (= St. John's, 17.x.1936, nos. 5–15; Pl. 53:A), the other, on a flan that is totally *flat* (= Temple E, SE, 15.v.1990, coin 90-215; Pl. 53:B).
- (71) Coin 96-114 has a long fracture possibly made with the intent of canceling the piece (Pl. 53). Coin 96-193 is preserved as a section of the original coin (“cut”).
- (77) This tournois is noteworthy for the reversal of the final character P (P with a tiny wedge in its back) of the obverse legend.
- (80) This Hungarian coin, rarely found in Greece, is variously attributed to Bela III (A.D. 1172–1196) or to Bela IV (A.D. 1235–1270) ruling jointly with his son Stephen (from 1254). See Réthy-Probst 100 (early date); Engel-Serrure (late date).
- (83) Octagonal clip. *Weight* 1.06 g.
- (84–92) Cordial thanks are due to Kenneth MacKenzie for reading and dating this entire series of Ottoman coins.
- (93) Coin 96-161 is a very debased aqche consisting of a copper core with applied silver wash. *Weight* 0.45 g.
- (106) The variety of Guy II de la Roche with GVIOT here listed is the first ever recorded in Corinth, the type being unknown in the Athenian Agora. The rarity of this tournois is also suggested by the Xirochori and Pylia hoards; see Tzamalis 1990, p. 102, chart, and Metcalf 1971, pp. 175, 188.
- (109) Coin 96-49 has the letter Y at the beginning of the reverse legend and a *pellet* at the end of the legend ($\cdot + Y$). The former mark seems to be the letter Y rather than a “trefoil”, as suggested by Metcalf (M., p. 279, a:ii); this is proved, firstly, by the form of the mark itself on the coin and, secondly, by another, unpublished variety in which an S replaces the Y ($\cdot + S$).
- (110) The obverse legend terminates with D'R , an odd case of lateral reversal of the customary D' R (Despotus Romanie); see M., p. 279, b:1.

Note on the Frankish Coins. Deformed or mutilated specimens are described in the Catalogue as they have been in the past. Thus coins cut into halves, quarters, or some other irregular shape are designated as “cut”; coins twisted, folded, or pounded into a rough shape are designated as “bent”. The nine uncertain coins of “Tournois” variety noted in the Catalogue (p. 189) but not individually listed are probably mostly Frankish. For other general remarks about the Frankish specimens, see my earlier report, Williams and Zervos 1990, p. 369.

BIBLIOGRAPHY

- Agora II* = M. Thompson, *Coins from the Roman through the Venetian Periods (The Athenian Agora II)*, Princeton 1954
- Amandry, M. 1988. *Le monnayage des duovirs corinthiens (BCH Supplément 15)*, Paris
- Antioch IV* = G. C. Miles, “Islamic Coins,” in *Antioch-on-the-Orontes, IV, i, Ceramics and Islamic Coins*, F. O. Waagé, ed., Princeton/London 1958, pp. 109–124
- BMC* = *A Catalogue of the Greek Coins in the British Museum*, London 1873–1963
- CopSNG* = *Sylloge Nummorum Graecorum, Copenhagen*, 1942–1977
- Corinth VI* = K. M. Edwards, *Coins, 1896–1929 (Corinth VI)*, Cambridge, Mass. 1933
- DOC* = *Catalogue of the Byzantine Coins in the Dumbarton Oaks Collection and in the Whittemore Collection*, A. R. Bellinger and P. Grierson, eds., Washington, D.C. 1966–
- Duplessy, J. 1988–1989. *Les monnaies françaises royales de Hugues Capet à Louis XVI (987–1793)*, Paris/Maastricht
- Engel, A., and R. Serrure. 1905. *Traité de numismatique du moyen âge II*, Paris
- Hendy, M. F. 1969. *Coinage and Money in the Byzantine Empire, 1081–1261*, Washington, D.C.
- LRBC* = R. A. G. Carson, P. V. Hill, and J. P. C. Kent, *Late Roman Bronze Coinage, A.D. 324–498*, London 1960

- Metcalf, D. M. 1971. "The Pylia Hoard: Deniers Tournois of Frankish Greece," *ANSMN* 17, pp. 173–227
- . 1995. *Coinage of the Crusades and the Latin East in the Ashmolean Museum*, 2nd ed., London
- North, J. J. 1994. *English Hammered Coinage I*, London
- Pere, N. 1968. *Osmanlılarda Madenî Paralar*, Istanbul
- Poey d'Avant, F. 1858–1862. *Monnaies féodales de France*, Paris
- Réthy, L., and G. Probst. 1958. *Corpus Nummorum Hungariae*, Graz
- RIC* = *The Roman Imperial Coinage*, H. Mattingly *et al.*, eds., London 1923–1994
- Sear, D. R., *et al.* 1987. *Byzantine Coins and Their Values*, 2nd ed. (Seaby Series), London
- Sydenham, E. A. 1975. *The Coinage of the Roman Republic*, rev. ed., New York
- Travaini, L. 1993. "Hohenstaufen and Angevin Denari of Sicily and Southern Italy: Their Mint Attributions," *NC* 153, pp. 91–135
- Tzamalīs, A. P. 1990. «Η πρώτη περίοδος του τραπεζιού», *ΝομΧρον* 9, pp. 101–128
- Warren, J. A. W. 1983. "The Autonomous Bronze Coinage of Sicyon," *NC* 143, Part 1, pp. 23–56
- Williams, C. K., II, E. Barnes, and L. M. Snyder. 1997. "Frankish Corinth: 1996," *Hesperia* 66, pp. 7–47
- Williams, C. K., II and J. E. Fisher. 1975. "Corinth, 1974: Forum Southwest," *Hesperia* 56, pp. 1–50
- Williams, C. K., II and O. H. Zervos. 1993. "Frankish Corinth: 1992," *Hesperia* 62, pp. 1–52
- . 1994. "Frankish Corinth: 1993," *Hesperia* 63, pp. 1–56
- . 1995. "Frankish Corinth: 1994," *Hesperia* 64, pp. 1–60
- . 1996. "Frankish Corinth: 1995," *Hesperia* 65, pp. 1–55

CORRIGENDUM

In *Hesperia* 64, 1995, p. 55:

No. 113 (Catalogue), last column, for 93-250 read 94-250.

ORESTES H. ZERVOS

CORINTH EXCAVATIONS
 c/o American School of Classical Studies
 54 Soudias Street
 GR-106 76 Athens
 Greece

